

Pure Sine Wave Inverter FI Series



Stable & Durable

Latest toroidal transformer could handle triple surge power.
Inbuilt AVR stabilizer for stable output



High Efficiency

Inverter transfer efficiency up to 85%
Inbuilt with 35A AC charger 99% efficiency



Battery Type

Support SLA/GEL/AGM battery

Connection

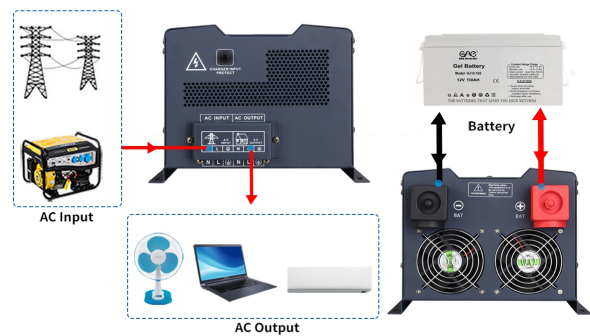

3D Visual

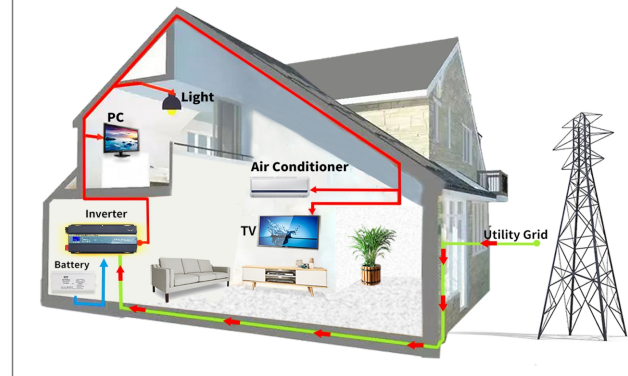

Technical Specification

Model	FI-152	FI-202	FI-302	FI-402	FI-502	FI-602
Rated power	1.5KW	2KW	3KW	4KW	5KW	6KW
Surge power	4.5KW	6KW	9KW	12KW	15KW	18KW
AC Input & Output						
Voltage	220VAC					
Selectable Voltage Range	165-275VAC (220VAC)					
Frequency Range	50Hz/60Hz automatic recognition					
AC Voltage Regulation (BATT. Mode)	(DC Batt.mode)220vac ±3%					
Transfer Time	≤4ms					
Wave Form	Pure Sine Wave					
Transformer type	Toroidal					
Transfer efficiency	≥85%					
Battery						
Battery Voltage	12V/24V/48V		24V/48V			
Type	Gel/SLA/AGM/ Lithium battery					
DC Charge Voltage	13.6-14.2VDC(12V)/27.2-28.4VDC(24V)/54.4-56.8VDC(48V)					
Overcharge Protection	Battery voltage ≥16VDC (12V) ≥32VDC (24V) ≥64VDC (48V), stop charging after 60s alarm					
AC Charger						
Maximum Ac Charge Current	35A (adjustable)					
Working mode						
01 mode	AC mains priority					
02 mode	ECO mode					
03 mode	DC battery priority					
Physical						
Packing size D*W*H(MM)	530*340*255			740*355*275		
G.W.(KGS)	16	18	20	31	33	35
Environment						
Humidity	0~95% (NO CONDESNSATION)					
Operating Temperature	0~60°C					
Storage Temperature	0~60°C					

*Product Specifications Are Subject To Change Without Further Notice